

## Doppelnippel - Reduziernippel

### Double Fittings - Reduction Fittings

Doppelnippel mit zylindrischen Gewinde M3 bis G3"  
 Double Fittings with cylindrical thread M3 to G3"

Art. No.	G 1	G 2	SW	L m m	L1 mm	L2 mm	Ø D mm
DN.M5M3	M5	M3	8	13	5	4	2
41.452	M5	M5	7	9,5	3	3	2,5
DN.M5M5	M5	M5	8	12	4,5	4,5	2,6
DN.18M5	G 1/8"	M5	14	15,5	6,5	4	2,3
DN.1818	G 1/8"	G 1/8"	14	16,5	6	6	6
DN.14M5	G 1/4"	M5	17	19	10	5	2,5
DN.1418	G 1/4"	G 1/8"	19	19	8	6	5,5
DN.1414	G 1/4"	G 1/4"	17	21	8	8	8
DN.3818	G 3/8"	G 1/8"	19	20,5	9	7	5
DN.3814	G 3/8"	G 1/4"	24	22	9	8	8
DN.3838	G 3/8"	G 3/8"	19	23	9	9	11
DN.1214	G 1/2"	G 1/4"	24	23,5	10	8	11
DN.1238	G 1/2"	G 3/8"	32	24	10	9	11
DN.1212	G 1/2"	G 1/2"	24	25,5	10	10	14
DN.3438	G 3/4"	G 3/8"	30	25,5	10	10	11
DN.3434	G 3/4"	G 3/4"	30	28	11	11	20
DN.3412	G 3/4"	G 1/2"	34	26,5	11	10	15
DN.1012	G 1"	G 1/2"	34	32,5	14,5	11	15
DN.1034	G 1"	G 3/4"	36	30	13	11	20
DN.1010	G 1"	G 1"	36	32	13	13	26
DN.11412	G 1 1/4"	G 1/2"	43	34	16	11	15
DN.11434	G 1 1/4"	G 3/4"	42	35	16	12	20
DN.11410	G 1 1/4"	G 1"	43	38,5	16,5	15	26
DN.114114	G 1 1/4"	G 1 1/4"	42	40	16,5	16,5	34
DN.11234	G 1 1/2"	G 3/4"	50	36	16	12,5	20
DN.11210	G 1 1/2"	G 1"	50	39	15,5	15,5	26
DN.112114	G 1 1/2"	G 1 1/4"	60	40	16	16	34
DN.112112	G 1 1/2"	G 1 1/2"	50	40	16,5	16,5	38
DN.2010	G 2"	G 1"	60	42	17	16	26
DN.20114	G 2"	G 1 1/4"	60	43	17	17	34
DN.20112	G 2"	G 1 1/2"	60	44	18	18	40
DN.2020	G 2"	G 2"	60	44	18	18	51
DN.21220	G 2 1/2"	G 2"	77	55	24	19,5	51
DN.212212	G 2 1/2"	G 2 1/2"	77	59	24	24	66
DN.3020	G 3"	G 2"	89	50	20	20	50
DN.30212	G 3"	G 2 1/2"	89	53	20	23	66
DN.3030	G 3"	G 3"	89	60	24,5	24,5	78

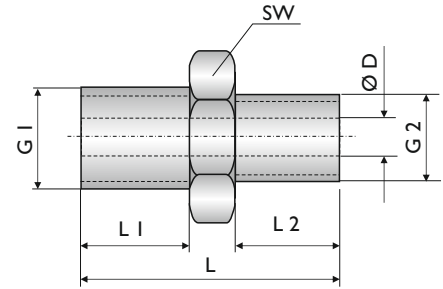

Massänderungen (ausser Gewinde) vorbehalten/  
 dimensional changes (except threads) are subject  
 to change

Material:  
 Messing vernickelt/nickel plated brass  
 (MSV = Standard)

Auf Anfrage/on request  
 Edelstahl/stainless steel

Reduziernippel mit zylindrischen Außen- und Innengewinde M3 bis G1"  
*Reduction Fittings with cylindrical external and internal thread M3 to G1"*

Art. No.	G 1	G 2	SW	L I mm	L mm
DNR.M5M3	M5	M3	7	1,5	6
DNR.M518	M5	G 1/8"	14	11	16
DNR.18M5	G 1/8"	M5	14	4	10
DNR.1818	G 1/8"	G 1/8"	14	10	16
DNR.1814	G 1/8"	G 1/4"	17	13,5	18
DNR.1838	G 1/8"	G 3/8"	22	14	20
DNR.1812	G 1/8"	G 1/2"	24	18	24
DNR.14M5	G 1/4"	M5	17	4	13
DNR.1418	G 1/4"	G 1/8"	17	5	13
DNR.1414	G 1/4"	G 1/4"	17	11,5	19,5
DNR.1438	G 1/4"	G 3/8"	19	20	26
DNR.1412	G 1/4"	G 1/2"	24	16,5	26
DNR.3818	G 3/8"	G 1/8"	19	5	14
DNR.3814	G 3/8"	G 1/4"	19	5	14
DNR.3812	G 3/8"	G 1/2"	24	16	26
DNR.1218	G 1/2"	G 1/8"	24	5	15
DNR.1214	G 1/2"	G 1/4"	24	6	15
DNR.1238	G 1/2"	G 3/8"	24	6	15
DNR.1234	G 1/2"	G 3/4"	32	17	27
DNR.3414	G 3/4"	G 1/4"	30	5	15
DNR.3438	G 3/4"	G 3/8"	30	5	16
DNR.3412	G 3/4"	G 1/2"	30	6	16
DNR.1012	G 1"	G 1/2"	36	6	19
DNR.1034	G 1"	G 3/4"	36	6	19

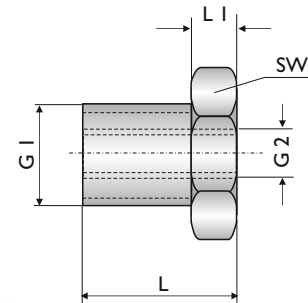

Massänderungen (ausser Gewinde) vorbehalten/  
*dimensional changes (except threads) are subject to change*

Material:  
 Messing vernickelt/nickel plated brass  
 (MSV = Standard)

Auf Anfrage/on request  
 Edelstahl/stainless steel

Weitere Komponenten im Programm auf Anfrage:

- Verschraubungen und Quickanschlüsse
- Mini-Steckverschraubungen
- Rotationsverschraubungen
- Sperranschluß-Steckverschraubungen
- Schnellkupplungen
- Verschraubungen für Reinräume, hohe Temperaturen und Chemikalien
- Verschraubungen in Edelstahl
- Verschraubungen antistatisch (ESD)
- Verschraubungen selbstverlöschend (UL94 V-O)
- Verschraubungen mit Festblenden von 0,1 - 2,0 mm

Further components in the program on request

- Screw connections and quick connections
- Mini screws connections
- Rotation screw connections
- Stopp fittings
- Quick couplings
- Connections for clean room, high temperatures and chemicals
- Connections in stainless steel
- Connections antistatic
- Screw Connections self-extinguishing (UL94 V-O)
- Screw Connections with fixed orifice of 0,1 - 2,0 mm



## Doppelnippel Serie „ATP“

### Double Fittings Series „ATP“

Innen-Außengewinde/ <i>internal-External Thread</i>									
Art. No.	R	Rc	A1 mm	A2 mm	B mm	L1 mm	SW	Ø mm	Gewicht Weight g
ATP.AM5.IM5	M5x0,8	M5x0,8	3	5	19,5	4	8	1,8	5
ATP.AM5.IM5.L		M5x0,8		5	23	4	8	1,8	6,5
ATP.AM5.I18		Rc1/8"		8	14,5	10	14	1,8	11
ATP.A18.IM5	R1/8"	M5x0,8	8	6	12	4	10	4,2	6
ATP.A18.I18		Rc1/8"		8	28,5	11	14	6	17
ATP.A18.I14		Rc1/4"		11	21	13	17	6	19
ATP.A18.I38		Rc3/8"		12	22	14	21	6	28
ATP.A14.IM5	R1/4"	M5x0,8	11	6	16	5	14	4,2	16
ATP.A14.I18		Rc1/8"		8	19	8	14	4,6	16,5
ATP.A14.I14		Rc1/4"		11	33	15	17	8	31,5
ATP.A14.I38		Rc3/8"		12	25	14	21	8	31,5
ATP.A14.I12	R3/8"	Rc1/2"	12	15	30	19	24	8	42,5
ATP.A38.I18		Rc1/8"		8	17,5	5,5	17	6	25
ATP.A38.I14		Rc1/4"		11	22,5	10,5	17	8	26,5
ATP.A38.I38		Rc3/8"		12	37	16	21	10	54
ATP.A38.I12		Rc1/2"		15	31	19	24	10	47,5
ATP.A12.I12	R1/2"	Rc1/2"	15	15	43	19	24	11	85

R = Außengewinde konisch  
*External thread conical*  
 Rc = Innengewinde konisch  
*Internal thread conical*

(nicht/not M5)

Material:  
 Messing vernickelt/*nickel-plated brass*

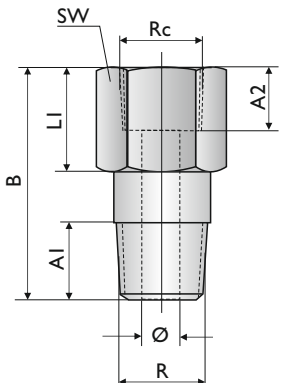

5

### Adapter mit Innengewinde / *Adapter with internal thread*

Art. No.	Rc1	Rc2	A1 mm	A2 mm	B mm	L1 mm	ØP mm	SW	Gewicht Weight g
ATP.I18.IM5	Rc1/8"	M5x0,8	8	5	17	7	8	14	11,5
ATP.I14.I18	Rc1/4"	Rc1/8"	11	8	21	8	14	17	22,5
ATP.I38.I18	Rc3/8"	Rc1/8"	12	8	22	8	14	21	31,5
ATP.I38.I14	Rc3/8"	Rc1/4"	12	11	25	11	17	21	35,5
ATP.I12.I14	Rc1/2"	Rc1/4"	15	11	30	11	17	24	51,5
ATP.I12.I38	Rc1/2"	Rc3/8"	15	12	33	14	21	24	59

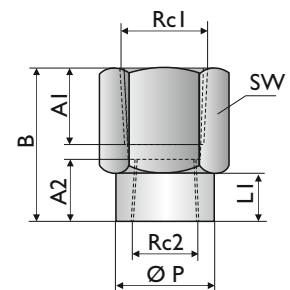

Rc1 + Rc2 = Innengewinde konisch  
*Internal thread conical*  
 (nicht/not M5)

Material:  
 Messing vernickelt/*nickel plated brass*